

## Handling System for Rack Type Pre-wash Table with Sink Left to Right, 900mm

ITEM # \_\_\_\_\_

MODEL # \_\_\_\_\_

NAME # \_\_\_\_\_

SIS # \_\_\_\_\_

AIA # \_\_\_\_\_



865403 (BHRPTB09L)

Prewash table with bowl for  
Rack Type Dishwasher, Left to  
Right, 900 mm

### Short Form Specification

#### Item No.

Designed for rack type dishwashers. Constructed in 304 AISI stainless steel. Integrated splashback.

N. 2 square 40x40mm tubular legs with height-adjustable feet.

Sink size 500x400x300mm with overflow pipe and drain hole. Basket direction: from left to right.

### Main Features

- Supplied knocked-down and easy to assemble.
- Designed for 500x500 mm dishwashing racks.
- The table is intended to be directly connected with the rack type in the loading side from left to right direction.
- Suitable to be installed alone with the rack type dishwasher to save space.

### Construction

- 304 AISI stainless steel construction throughout.
- Included splashback to prevent water spatter.
- Deep anti-drip profiles completely folded with lower edge for safe and easy cleaning.
- All surfaces smooth with polished finish.
- 40x40 mm square tubular legs in AISI 304 stainless steel.
- To be secured to the dishwasher and fitted with one pair of legs at the other end.
- Optionally equipped with undershelf, pre-rinse unit, strainer basket and scrap plate.

### Sustainability



- Stainless steel feet 50 mm adjustable in height to align the operation height between the dishwasher and table as well as to ensure that tables drain back into the dishwasher.

### Optional Accessories

- Dish scraper PNC 855297 ☐
- Floor fastening kit for 2 square legs PNC 865386 ☐
- Removable bridge table, 800 mm PNC 865418 ☐
- Removable bridge table with hole, 800 mm PNC 865419 ☐
- Undershelf for dishwasher table, 900 mm PNC 865479 ☐

APPROVAL: \_\_\_\_\_



**Electrolux**  
PROFESSIONAL

## Handling System for Rack Type Pre-wash Table with Sink Left to Right, 900mm

Front

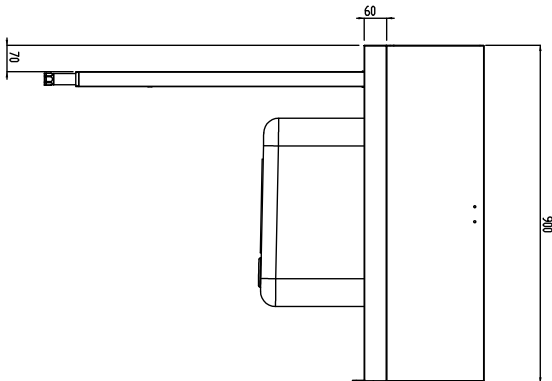

Side

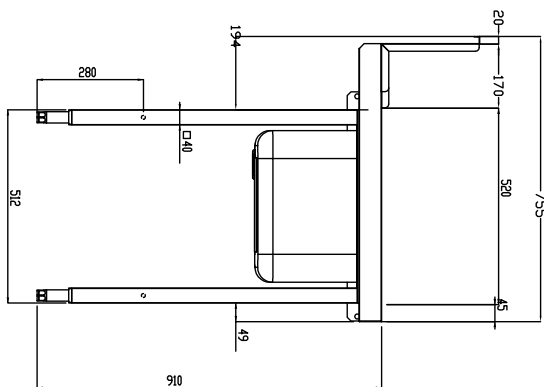

D = Drain

Top

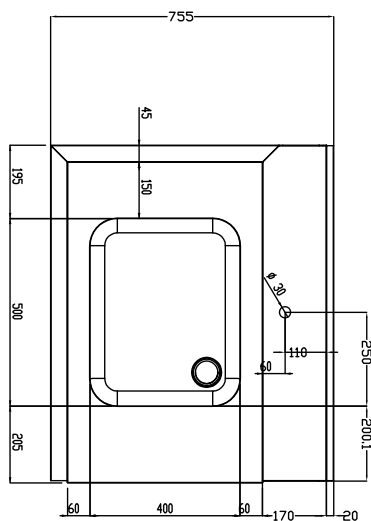

### Key Information:

External dimensions, Width:  
865403 (BHRPTB09L) 900 mm

External dimensions, Depth: 755 mm

External dimensions, Height: 1170 mm

Net weight: 19 kg

Splashback Dimensions,  
Height: 260 mm

Basin dimensions:

Handling System for Rack Type  
Pre-wash Table with Sink Left to Right, 900mm

The company reserves the right to make modifications to the products  
without prior notice. All information correct at time of printing.

2025.04.19